



FACILITIES AND SERVICES

- 446 Well-appointed guest rooms
- 15 Suites
- Sweet Dreams by DoubleTree™ sleep experience
- Electronic RFID door locks
- The Peel Craftbar & Kitchen, offering breakfast, dinner, appetizers & craft cocktails
- Starbucks® beverages with grab-and-go breakfast & lunch items from K2 Koffee Kitchen
- Knock & drop breakfast & dinner room service
- 24/7 Sundry shop
- Bell services
- 24/7 Fitness center featuring PreCor® & Peloton®
- Outdoor pool
- Tennis court

MEETINGS AND EVENTS

The ideal meeting & event venue, Hotel FERA, a DoubleTree by Hilton™ offers approximately 30,000 sq. ft. of flexible indoor/outdoor function space. Meeting services include in-house A/V, first-class catering & a dedicated staff to ensure your event is a success.

- Grand Ballroom, able to accommodate up to 1,000 guests & divisible into 6 smaller spaces
- California Ballroom, able to accommodate up to 350 guests & divisible into 3 smaller spaces
- Expansive foyer space offering floor-to-ceiling windows & natural light
- Flexible outdoor space options which can accommodate up to 1,000 guests
- 10 Meeting rooms, able to accommodate groups of 10 – 100; all offering windows & natural light

LOCATION

Conveniently located off the I-5 Freeway & adjacent to the 22, 57 & 55 Freeways, Hotel FERA, a DoubleTree by Hilton™ offers easy access to all of Orange County's premier attractions.

- The Outlets at Orange – adjacent - 5 minute walk
- Angel's Stadium – 1 mile
- Honda Center – 2 miles
- GardenWalk – 2 miles
- Anaheim Convention Center – 2.5 miles
- Disneyland® Resort – 2.5 miles
- Platinum Triangle – 3 miles
- John Wayne Airport-Orange County (SNA) – 10 miles
- Huntington Beach – 18 miles

HOTEL

FERA

a **DOUBLETREE** by Hilton™

100 The City Drive
Orange, CA 92868-3204
Tel (714) 634 4500

AnaheimOrangeCounty.DoubleTree.com
@DoubleTreeAnaheim

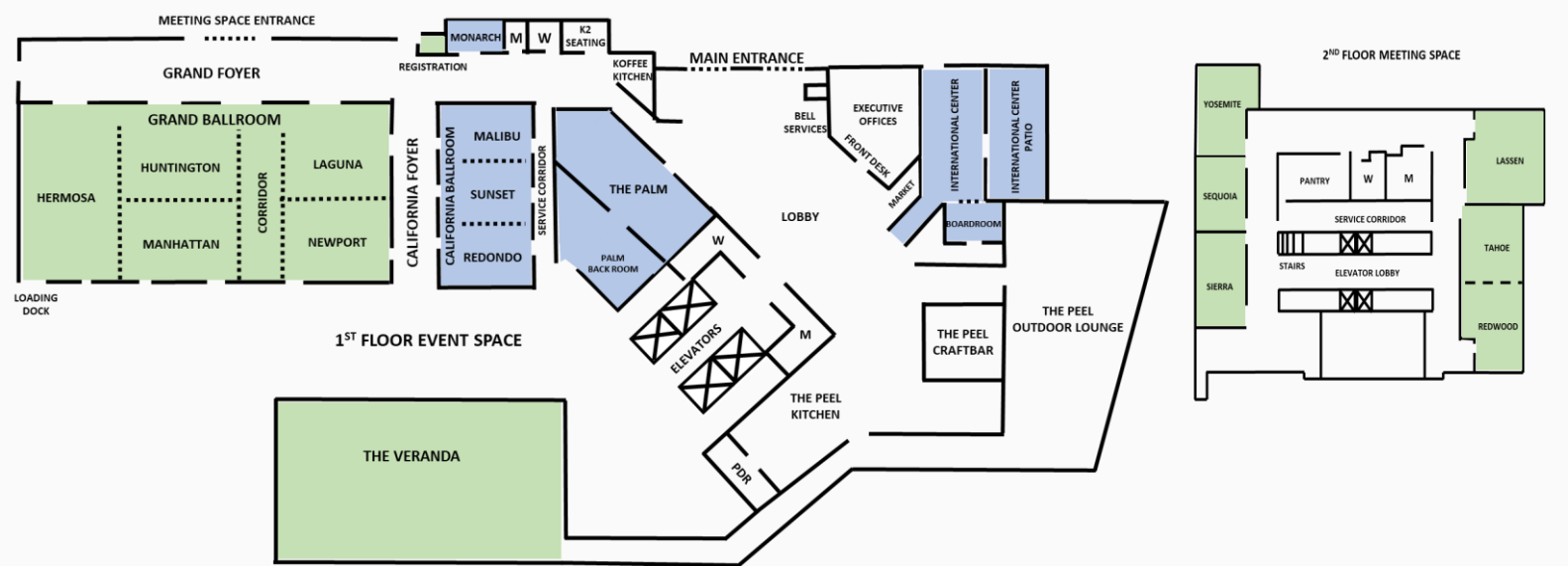

Room	Sq. Ft.	Dimensions	Ceiling	Classroom	Theatre	Banquet	Reception	Conference	U-Shape
1ST FLOOR									
California Ballroom	2,960	73' x 39'	12'	120	300	160	250	60	65
California Foyer	1,050	70' x 15'	12'	-	-	-	100	-	-
Malibu & Sunset	1,974	49' x 39'	12'	80	200	120	180	40	40
Sunset & Redondo	1,974	49' x 39'	12'	80	200	120	180	40	40
Malibu	987	24' x 39'	12'	40	100	50	90	30	30
Redondo	987	24' x 39'	12'	40	100	50	90	30	30
Sunset	987	24' x 39'	12'	40	100	50	90	30	30
Monarch				-	-	-	-	6	-
Grand Ballroom	8,085	66 x 122'	16'	450	1,000	500	1,000	100	120
Grand Foyer	2,574	117' x 22'	16'	-	-	-	200	-	-
Hermosa, Huntington, Manhattan	4,620	66' x 70'	16'	220	550	280	200	76	74
Hermosa, Huntington, Manhattan, Corridor	5,775	66' x 87'	16'	400	800	350	500	76	92
Huntington, Manhattan	2,310	66' x 35'	16'	100	200	150	180	52	62
Huntington, Manhattan, Corridor	3,465	66' x 52'	16'	120	400	200	250	52	65
Huntington, Manhattan, Corridor, Laguna, Newport	5,775	66' x 87'	16'	400	800	350	500	90	120
Laguna, Newport, Corridor	3,465	66' x 52'	16'	160	400	200	250	52	65
Laguna, Newport	2,310	66' x 35'	16'	100	200	150	200	50	60
Hermosa	2,310	66' x 35'	16'	120	200	150	200	50	60
Huntington	1,216	35' x 35'	16'	45	100	60	90	30	34
Manhattan	1,094	31' x 35'	16'	45	100	60	90	30	34
Corridor	1,155	66' x 17'	16'	-	-	-	-	-	-
Laguna	1,216	35' x 35'	16'	45	100	60	90	30	34
Newport	1,094	31' x 35'	16'	45	100	60	90	30	34
International Center	1,460	25' x 52'	12'	40	75	60	100	30	25
International Center Patio	2,735	-	-	-	-	-	100	-	-
Boardroom	524	-	-	-	-	-	-	10	-
Palm	1,450	-	12'	70	100	90	100	-	-
Palm Back Room	850	-	12'	-	-	40	90	-	-
Veranda	7,200	-	-	450	1,000	500	1,000	-	-
2nd FLOOR									
Lassen	1,036	27' x 39'	9'	45	100	60	75	30	30
Redwood	624	26' x 24'	9'	36	45	40	60	20	25
Tahoe	576	19' x 24'	9'	15	25	30	40	15	20
Redwood Tahoe	1,050	45' x 24'	9'	75	100	70	80	30	30
Sequoia	624	26' x 24'	9'	30	50	40	60	20	25
Sierra	804	18' x 24'	9'	54	70	60	100	30	30
Yosemite	676	25' x 27'	9'	30	50	70	60	22	27

